

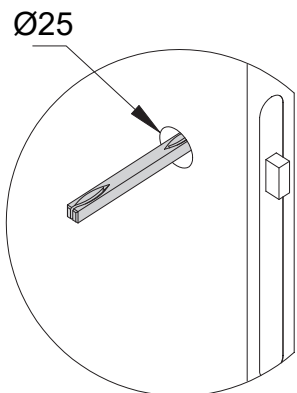

Montaje manillas DECO roseta 6mm / Assembly DECO handles rose 6mm

1. Pon el cuadradillo en la cerradura
Put the square drive in the lock



2. Coloca el soporte - plantilla
Remove the guide

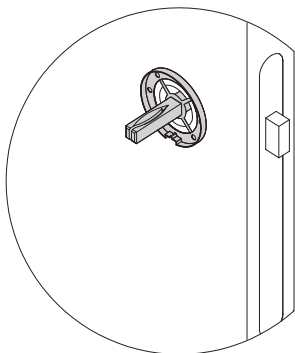

3. Atornilla el soporte a la puerta
Screw the support to the door

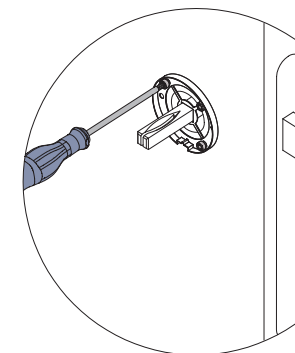
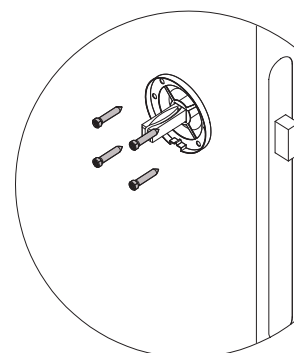

4. Retira el cuadradillo y rompe la zona central de plantilla
Remove the square drive and break the central part

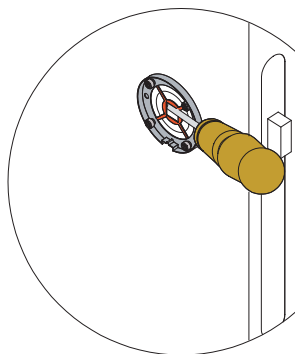
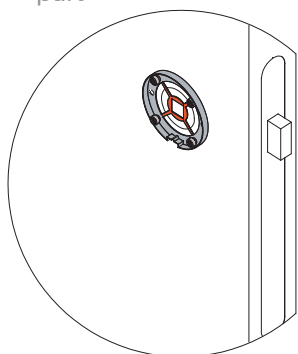

5. Resituamos el cuadradillo
Relocate the square drive

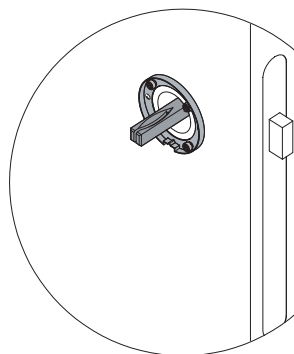

6. Montamos la manilla y fijamos con los 2 prisioneros
We set up the handle and we lock it with the sharp threads

